

FREQUENTLY ASKED QUESTIONS

When will construction start? How long will it take?

It depends on various factors, including the contractor, availability of materials, permits and funding progress, but construction will hopefully start in late summer or early fall and take approximately three months.

How will it be funded?

We're pursuing multiple funding avenues, including grants, local philanthropic organizations, and donations from patrons and area residents as part of a capital campaign.

Thanks to the library's long-term investment of legacy gifts from private donations, this project will also be partially funded from the returns these investments have achieved, while preserving the initial capital for the library's future funding needs. No library operating funds or municipal/state funds are being used for this project.

What will happen to the Unity sculpture, benches, etc.?

As part of the planning process, we're working with both the Emmaus Arts Commission and Emmaus Parks to have the existing sculptures (within the new plaza area) relocated to their future home within a proposed 'arts park' on the lawn near the library.

Will the library entrance be blocked during construction?

Working with our construction vendor, we'll do everything possible to ensure safety and minimize disruptions. We'll provide advance notice on the library's website and social media in the case of such an event.

Follow along
as the project unfolds...

Project and fundraising updates will be posted at emmauspl.org/enter, as well as the library's monthly newsletter, *Belong*.

Be part of the
library's next
chapter...



Help
the library
open new doors!

...and help create
a more welcoming future
for generations to come.

Contribute at
emmauspl.org/enter
by mail, at the desk,
or with Venmo



venmo

A NEW
ENTRANCE & PLAZA
will create a
bright, accessible
and inviting space
for our community



SERVING EMMAUS, MACUNGIE & UPPER MILFORD

Thank you!

Our 60-year-old entrance has seen better days and needs a makeover!



cracked sidewalk



no overhead cover



crumbling wall

Since 1966...

the entrance of Emmaus Public Library has opened to thousands of learners and explorers of all ages. And it shows.

Last year, the overhead portico was removed for structural reasons, leaving the entrance exposed to the elements. The sidewalk is cracked, and the brick half-wall is crumbling.

A lot of work has gone into upgrading the library's interior in recent years--including a new children's wing and circulation desk, new carpeting, and more.

Now the exterior needs our attention

The new entrance and plaza will create:

- A sheltered, accessible entryway
- Better visibility to the parking area
- Outdoor space to hold library events and for people to gather
- A fresh, modern look using simple, sustainable materials

...and the plaza will showcase our unique and colorful community mosaic.

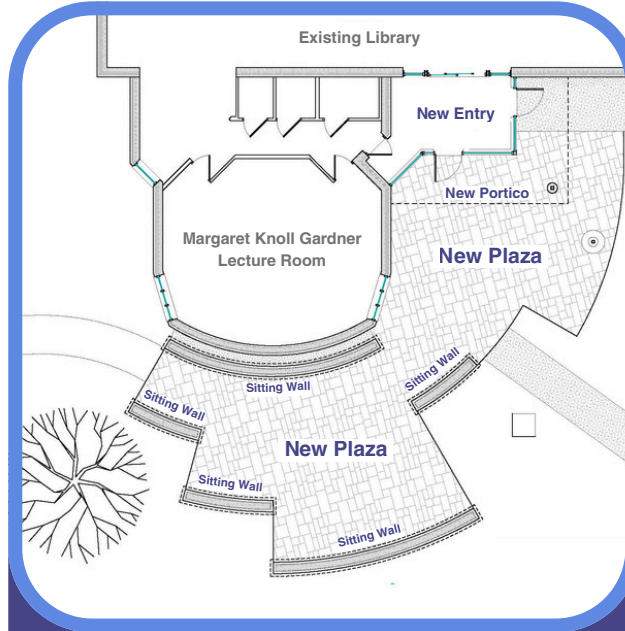

The fundraising goal is \$200K.

Your contribution helps make this project possible.

Enclosed is my contribution of \$_____ for the Emmaus Public Library Entrance & Plaza Project Capital Campaign.

Name _____

Address _____

Email _____

Phone _____

Please send checks to: **Emmaus Public Library**
11 E. Main St., Emmaus, PA 18049

- \$25 Bookmark
- \$50 Reader
- \$100 Book Lover
- \$500 Storyteller
- \$1,000 Author
- \$2,500 Editor
- \$5,000 Publisher
- \$10,000 Legacy

Donor will be publicly thanked. Please check here if you wish to remain anonymous